

ROLLER SHADES

Cordless



3DAYBLINDS®
YOU'LL LOVE THE TREATMENT

GETTING STARTED

A few simple tools are required:



Steel Tape Measure



Pencil

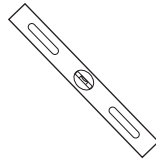

Level
(for outside mount)



Power Drill and
Drill Bits



Flathead & Phillips
Screwdriver



Awl (or tool for
starting a screw hole)

OPTIONAL HARDWARE

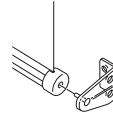

Hold Down Bracket



Spacers

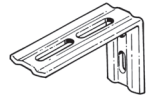

L-Bracket

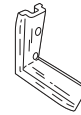

Plastic Corner



Wing Nut and Bolt

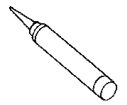

Glue

BRACKET INFORMATION

The brackets you received with your product are **REQUIRED** for proper installation. Brackets should be installed at each end and any additional brackets will need to be evenly spaced between the two end brackets.

STANDARD HARDWARE



Mounting Bracket

INSIDE MOUNT

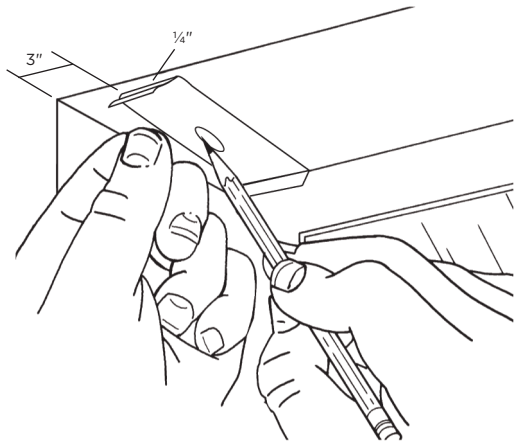

- Brackets should be installed 3" in from each corner of the window and 1/4" back from the front edge of the window casing. Using a pencil, mark the position of the bracket holes on your wall or molding.
- Additional brackets, if included, are REQUIRED for proper installation and should be installed evenly spaced between the two end brackets.
- Proceed to "Shade Installation".

OUTSIDE MOUNT

NOTE: You will be using your shade with mounting brackets attached to the headrail to mark the position of the brackets on your wall or molding.

- Attach brackets to the headrail. Additional brackets, if included, are REQUIRED for proper installation and should be spaced evenly over the width of the headrail. Lower the shade to its full length. (See "Shade Operation".)

NOTE: If using extension brackets, attach mounting brackets to extension brackets with nuts and bolts before attaching brackets to the headrail. (See "Optional Accessories".)

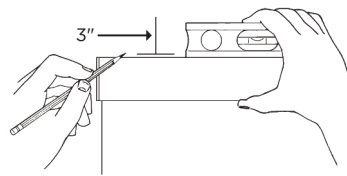

- Hold the shade up to the desired mounting position over the window. Once the shade is level, mark the wall or molding on either side and top of each mounting bracket.

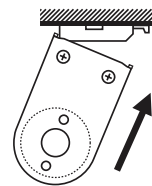

- Remove the mounting brackets from the headrail by pushing the metal release tab on each bracket.

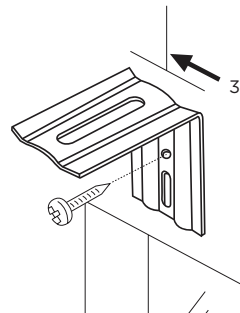

- Fasten brackets to wall where marked 1 1/2" of the flat mounting surface is required to mount your shade.

END MOUNT

An end mount is recommended for shades being installed with an arch top or for inside mount applications where there is no alternative mounting surface.

NOTE: You will be using your shade with mounting brackets attached to the headrail to mark the position of the brackets in your window opening.

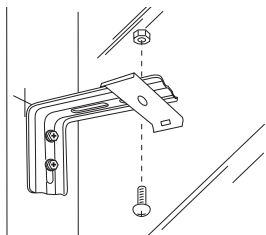

- Attach the mounting brackets to each extension bracket using the holes indicated in the diagram. Attach brackets to the headrail 3" from wall. Lower the shade to it's full length. (See "Shade Operation".)

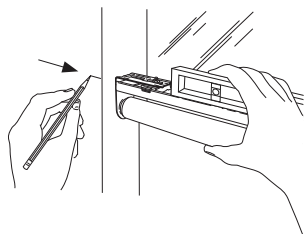

- With the mounting brackets attached, hold the shade up to the desired mounting position inside the window casing.

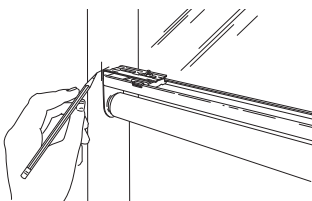

- Once the shade is level, recess the shade 1/4" from the front edge of the window casing and mark the wall on the front side and top edge of each extension bracket.

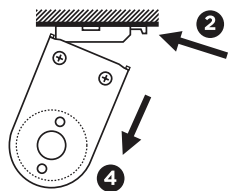

- Remove the mounting brackets from the headrail by pushing the metal release tab on each bracket.

NOTE: Diagram does not show extension bracket.

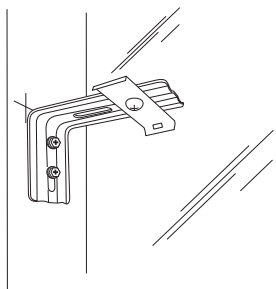

- Install an assembled end mounting bracket at each set of marks in your window opening.

SHADE INSTALLATION

NOTE: Professional installation is recommended.

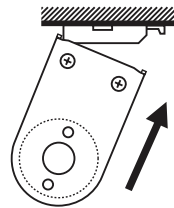

- Place the front of the headrail into the front hook of the bracket.

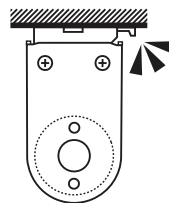

- Rotate the headrail up and snap into place

NOTE: Shade must be installed level for fabric to roll evenly when raised and lowered

OPERATION ADJUSTMENT

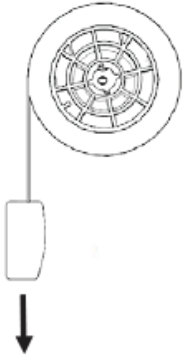

- Pull the bottom rail down to the bottom location.
- The shade will raise approximately 1 ¼" to find a locked position.
- Tug gently on the bottom rail and the shade will automatically rise. As the limits are not set, ensure the bottom rail is controlled so the shade doesn't spring into the cassette and damage the fabric.
- If the shade raises as the desired speed, the correct number of pre-turns have been set and no further adjustments may be required when the limit is set.

SETTING THE TENSION

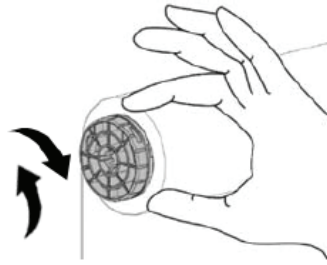

- To adjust the tension of the shade when it operates too quickly or slowly, adjust the wheel located opposite the limit.
- Roll the wheel toward the back of the shade to decrease the tension. To increase the tension, roll the wheel toward yourself.

NOTE: Rotate in the opposite direction for a Reverse Roll Shade.

SETTING THE TOP LIMIT

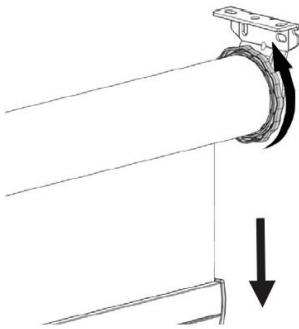

- Start with the shade fully raised.
- To lower the top limit position, rotate the limiter head so that the shade moves down.

NOTE: Rotate in the opposite direction for a Reverse Roll shade.

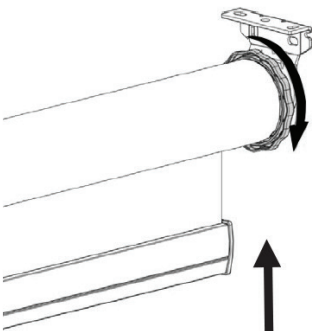

- To raise the top limit position, rotate the limiter head to that the shade raises.

NOTE: Rotate in the opposite direction for a Reverse Roll shade.

SHADE OPERATION

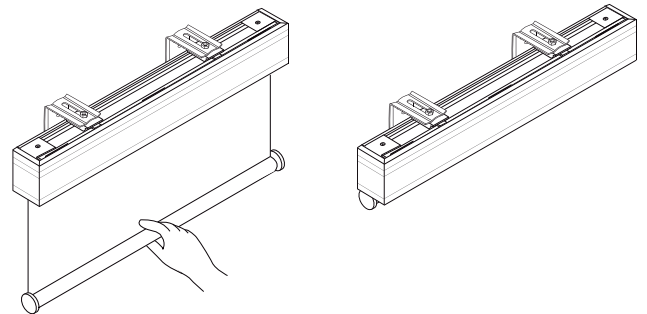

- To raise the shade completely, pull gently on the bottom rail and release.
- To stop the shade at a desired height, pull gently on the bottom rail, and while continuing to hold the bottom rail, direct the shade to the desired position. Release the bottom rail when the shade is in the desired position.
- To stop the shade at a desired length, pull the shade slightly lower until the mechanism catches. This may require the shade to be pulled away from the window sill.
- Do not place items inside the window frame that will interfere with the even operation of the shade.

SHADE REMOVAL

NOTE: Window covering removal is much easier and safer with two people.

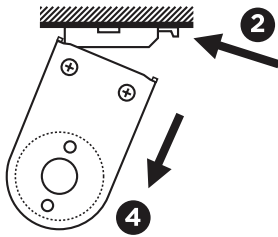

- Raise the shade completely.
- Locate the metal release tab on each bracket.
- Starting at one end of the shade, push the release tabs to unlock the headrail from the bracket.
- Repeat for each bracket until the shade is free from all brackets.

OPTIONAL ACCESSORIES

HOLD DOWN BRACKETS

Hold down brackets are used primarily on shades mounted to doors or in motor homes. There are two small holes in the end caps. Use the pin on the hold down bracket to push through the hole in the end cap.

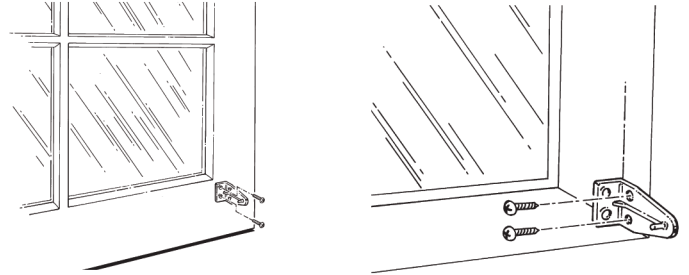

- With the shade lowered to its full length, place the pin of each hold down bracket into the hole in each end of the bottom rail.
- Mark the mounting surface, either to the side or back of the window frame, through the holes in the hold down bracket. Make sure the hold down brackets are level and aligned with each other.
- Raise the shade and screw the hold down brackets into the mounting surface using the screws provided.

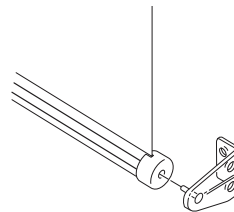

- Lower the shade and flex the hold down bracket outward so that the pin can be inserted into the hole in the end cap.

CORONADO AND MANHATTAN VALANCES

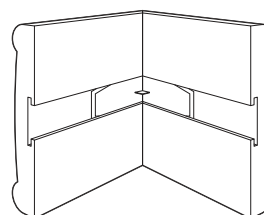
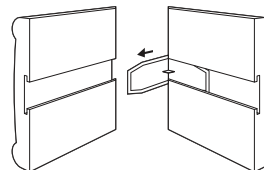
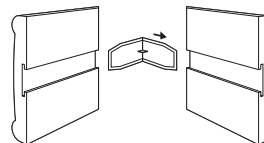
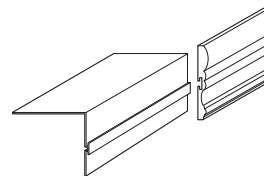

- Insert plastic corner into the valance and returns.
- If the valance returns are short, glue will be included instead of plastic corners. Apply a thin coat to the mitered end of both the valance and the returns.
- Join the ends of the valance returns with the valance by pressing the mitered edges together firmly for 60 seconds. Allow the glue to dry for at least 10 minutes before installing the valance.

CORONADO AND MANHATTAN VALANCES (INSIDE MOUNT)

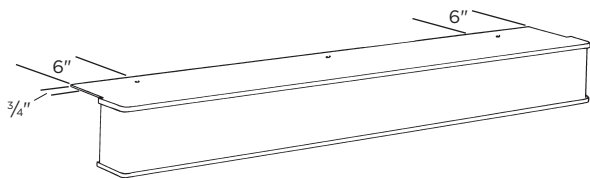

- To install, the valance must be pre-drilled. Using a pencil, mark pilot holes 6" in from each end of the valance and $\frac{3}{4}$ " in from the back of the valance. If additional brackets were sent with your valance mark additional pilot holes evenly spaced over the remaining width of the valance. Drill holes at the pencil marks using a $\frac{1}{16}$ " drill bit.

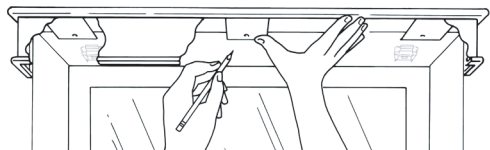

- Position the valance so that the plastic dust cover on the top of the valance fits inside of the window frame and the valance returns butt up against the wall on the outside of the window frame.
- Using the pencil, mark the window sill through the holes in the valance.

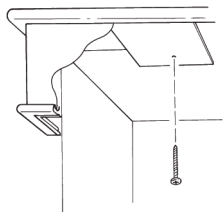

- Install valance using the screws provided.

CORONADO AND MANHATTAN VALANCES (OUTSIDE MOUNT)

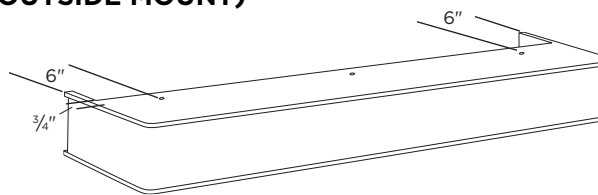

- To install, the valance must be pre-drilled. Using a pencil, mark pilot holes 6" in from each end of the valance and $\frac{3}{4}$ " in from the back of the valance. If additional brackets were sent with your valance mark additional pilot holes evenly spaced over the remaining width of the valance. Drill holes at the pencil marks using a $\frac{1}{16}$ " drill bit.

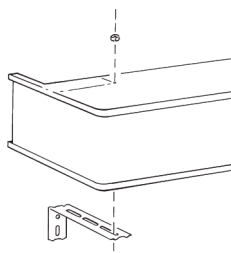

- Once the extension brackets are installed, position the valance over the window and roller shade

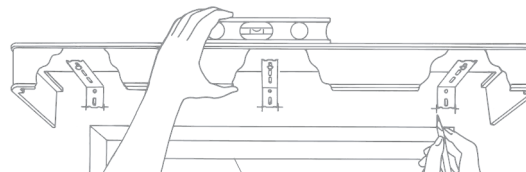

NOTE: The valance should be positioned to cover the top of the shade roll. Please leave enough room to allow the shade to operate properly. Using the level and a pencil, mark the bottom corners of each extension bracket.

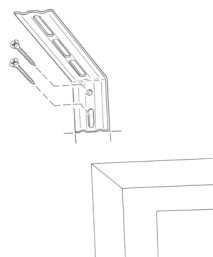

- Remove the extension brackets from the valance and install them using the screws provided.



3DAYBLINDS®
YOU'LL LOVE THE TREATMENT

800-800-3329 | 3dayblinds.com

Part # PM-051 © 3 Day Blinds LLC 05/18